

1  
RoHS Compliance

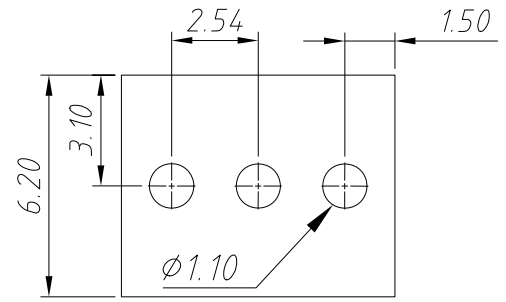

PCB LAYOUT

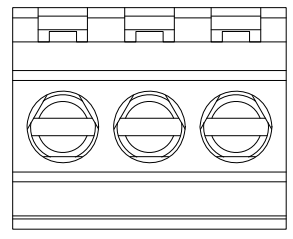
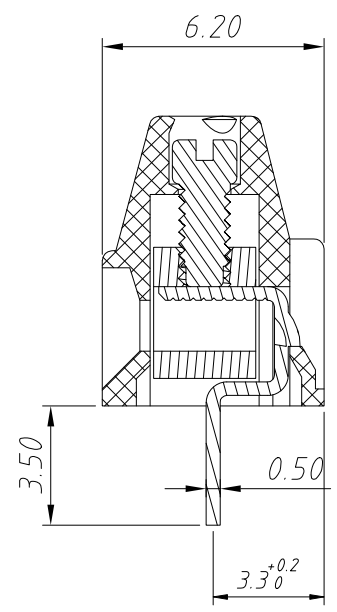
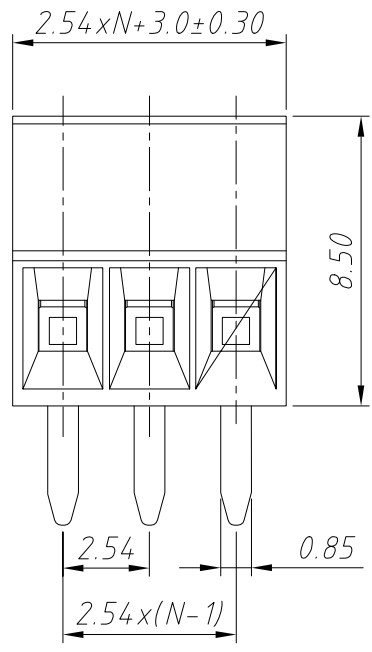

SECTION

Material  
Screw: M1.5, steel, Zn plated  
Cage: Brass, Nickel plated  
Pin header: Brass, Tin plated  
Housing: PA66, UL94V-0, Green

Electrical  
Rated voltage: 125V  
Rated current: 6A  
Wire range: 28~18AWG 1.0mm<sup>2</sup>  
Contact Resistance: 20 mΩ  
Insulation resistance: 500MΩ/DC500V  
Withstand voltage: AC1250V / 1 min

Mechanical  
Temp. Range: -40 °C ~ +105 °C  
Soldering: 250 °C 5Sec. Max.  
Torque: 0.45 Nm (1.3Lb.) in  
Strip length: 3.7~4.7 mm

Order Information

L-KLS2-308V-2.54-XXP-4 S XX

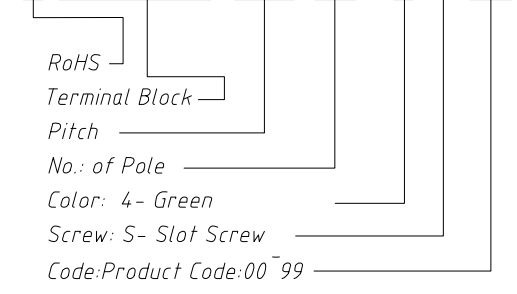

ANGLE TOLERANCE	PROJECTION		Description:		
±3°			2.54mm Screw Terminal Block Rising clamp		
GENERAL TOLERANCE	UNITS	mm	KLS P/N:	L-KLS2-308V-2.54-XXP-4S	
x.x ±0.30	SHEET SIZE	A4		NingBo KLS ELECTRONIC CO.,L TD.	
x.xx ±0.20	Draw:	Daniel			2022-05-15
x.xxx ±0.10	Check:	Daniel			2022-05-15