

Material:
 Connector body: Brass, Gold Plating
 Center Contact: Ber. Copper, Gold Plating
 Insulator: Teflon, Natural
 Ferrule: Copper, Gold Plating

Electrical Specifications:
 Impedance: 50Ω
 Durability: 500 Cycles

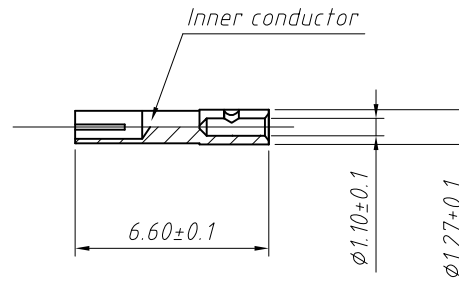
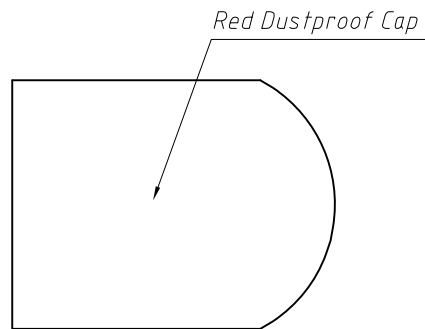

Order Information

L-KLS1-SMA013-RG55

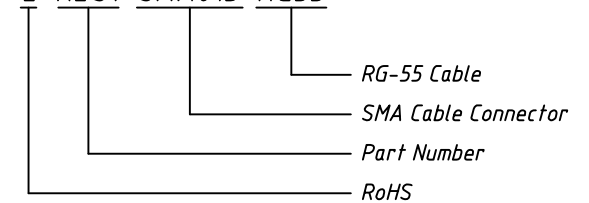

GENERAL TOLERANCE	PROJECTION		Description:
X. ±0.50	UNITS	mm	SMA Cable Connector
.X ±0.25	SCALE	1:1	Straight (Plug, Female, 50Ω) RG-58, RG-55
.XX ±0.10	Draw by:	Jenny	KLS P/N: L-KLS1-SMA013-RG55
ANGLE TOLERANCE	Check by:		
X. ±5°	Date	2018-03-01	NingBo KLS ELECTRONIC CO., L TD.
.X ±3°	SHEET	1 OF 1	
.XX ±2°			