

1  
RoHS Compliance

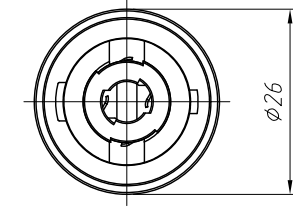
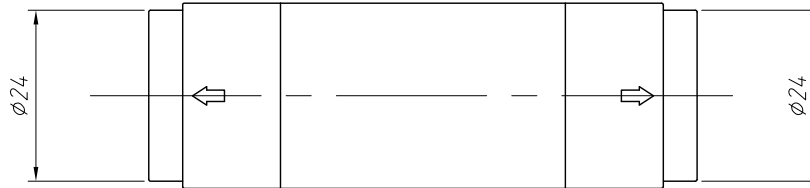
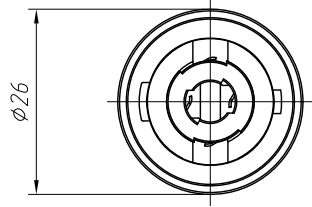

**Electrical:**

- 1.Voltage Rating: 250VAC
- 2.Current Rating: XLR:20A Max.  
JACK: 15A Max.
- 3.Contact Resistance: 30mΩ Max.
- 4.Insulation Resistance: 1000MΩ Min.
- 5.Withstanding Resistance :1000VAC Min.

**Mechanical:**

- 1.Durability: 1000 cycles Min.
- 2.Insertion Force: 5~20N
- 3./withdrawal Force: 5~20N.

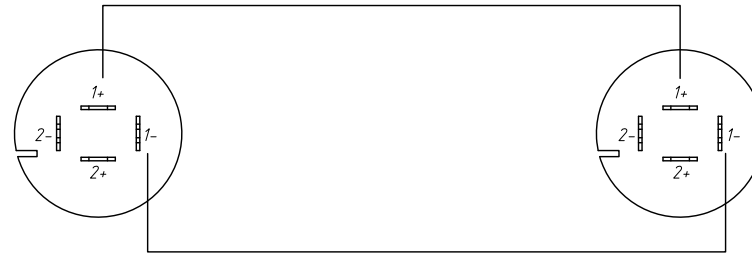

**Order Information:**

L-KLS1-SL S-0610-04-BK

L: RoHS  
speakON series

Type: S-socket P-Plug

Order Number

No.of 04 pins

Color:BK-Black

ANGLE TOLERANCE	PROJECTION	Description:	
±3°		ADAPTER 4 pole SPEAKON CONNECTOR4	
GENERAL TOLERANCE	UNITS	mm	KLS P/N:
x.x ±0.30	SHEET SIZE	A4	L-KLS1-SLS-0610-04-BK
x.xx ±0.20	Draw:	Daniel	2021-08-28
x.xxx ±0.10	Check:	Daniel	2021-08-28



NingBo KLS ELECTRONIC CO.,LTD.