

1
RoHS Compliance

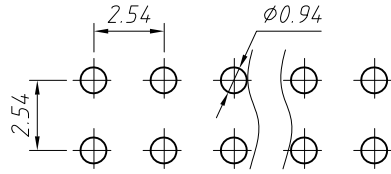
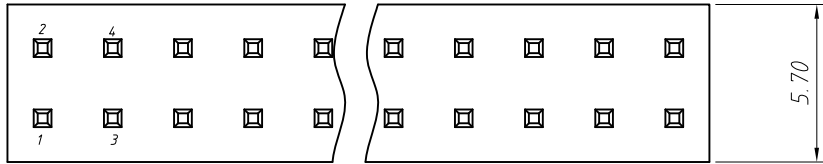

Recommended P.C.B Hole Layout

Material:
Standard: PA6T, UL 94V-0
Contact: Brass

Electrical Characteristics:
Rated Current: 3AMP
Contact Resistance: 20mΩ Max
Withstand Voltage: 1000V AC/DC
Insulator Resistance: 1000MΩ Min
Withstanding Voltage: AC 500V

Mechanical
Operating Temperature: -40°C ~ +105°C

Order Information:

L-KLS1-207L-2-XX-S-L1xL2xL3-G0

L: RoHS
Pin Header Series
207L: 2.54mm
Per Row: Dual Row
Pin: No. of Pins (02~80)
Type: Straight Pin
Size: L1xL2xL3
Plating:
G0=Gold Flash G1=1u" Gold
G10=10u" Gold G15=15u" Gold
G30=30u" Gold

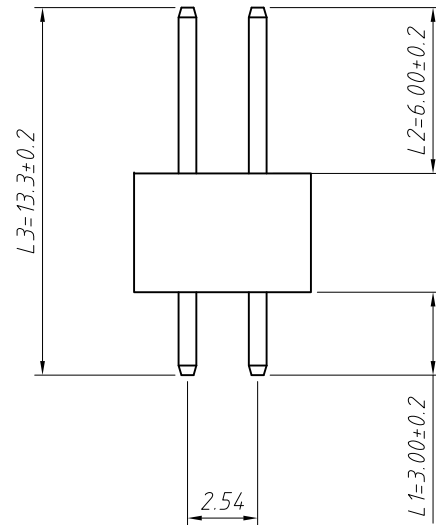
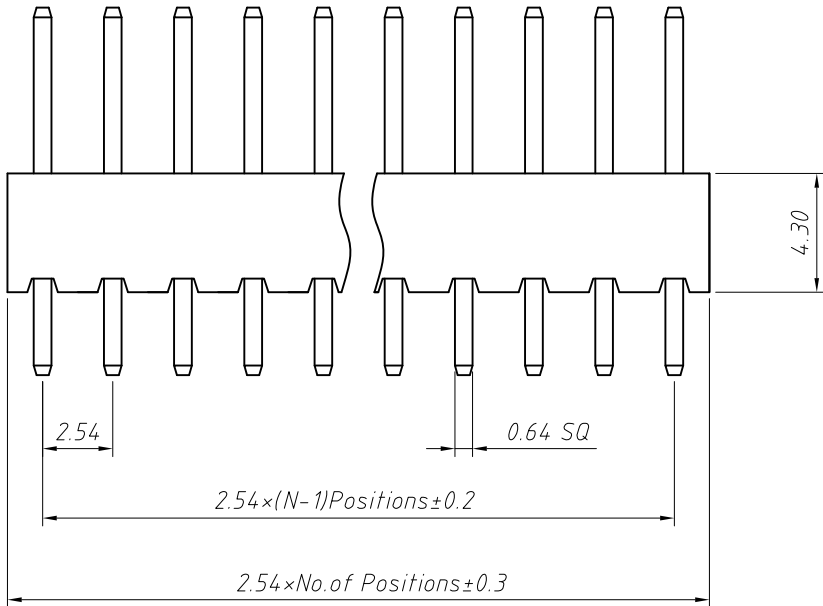

Dimension antitheses list (mm)

ITEM	L1	L2	L3	Plastic Height
Standard	3.00	6.00	13.30	4.30
Nonstandard	---	---	---	---

ANGLE TOLERANCE	PROJECTION	Description:
±3°		2.54x4.3 Pin Header Dual Row, Straight Pin, 2xN Pin
GENERAL TOLERANCE	UNITS	mm
x.x ±0.30	SHEET SIZE	A4
x.xx ±0.20	Draw:	Daniel 2018-07-10
x.xxx ±0.10	Check:	Daniel 2018-07-10



NingBo KLS ELECTRONIC CO.,L TD.

1
RoHS Compliance

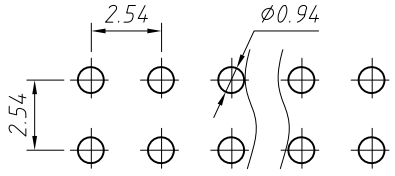
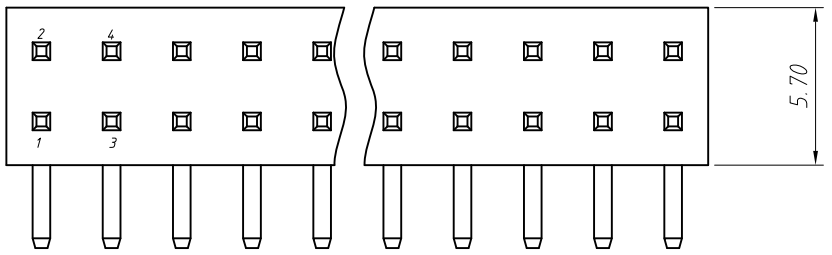

Recommended P.C.B Hole Layout

Material:
Standard:PA6T,UL 94V-0
Contact: Brass

Electrical Characteristics:
Rated Current: 3AMP
Contact Resistance: 20mΩ Max
Withstand Voltage: 1000V AC/DC
Insulator Resistance: 1000MΩ Min
Withstanding Voltage:AC 500V

Mechanical
Operating Temperature: -40°C ~ +105°C

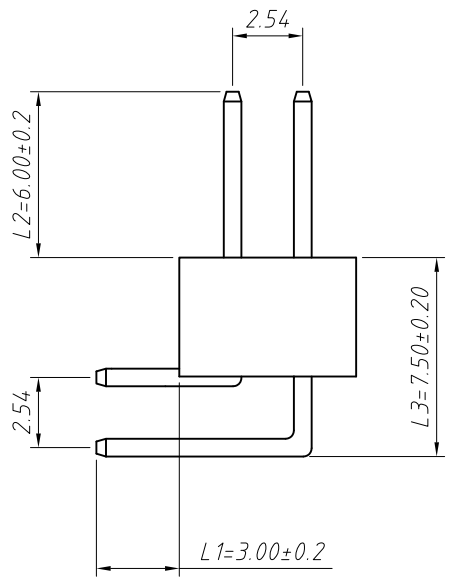
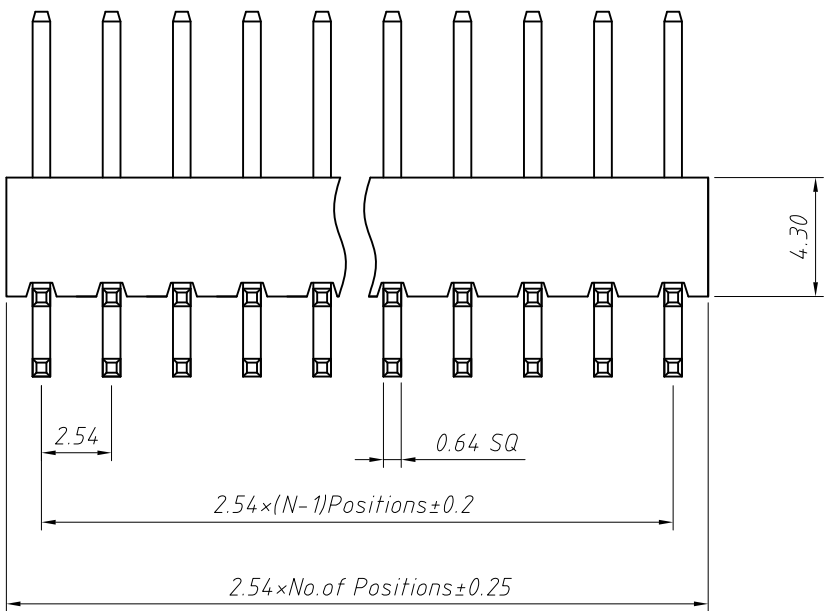

Order Information:
L-KLS1-207L-2-XX-R-L1xL2xL3-G0

L: RoHS
Pin Header Series
207L:2.54mm
Per Row: Dual Row
Pin: No. of Pins (02 ~ 80)
Type: Right Angle Pin
Size: L1xL2xL3
Plating:
G0=Gold Flash G1=1u" Gold
G10=10u" Gold G15=15u" Gold
G30=30u" Gold

Dimension antitheses list (mm)

ITEM	L1	L2	L3	Plastic Height
Standard	3.00	6.00	7.50	4.30
Nonstandard	---	---	---	---

ANGLE TOLERANCE	PROJECTION	Description:
±3°		2.54x4.3 Pin Header Dual Row, Right Angle Pin, 2xN Pin
GENERAL TOLERANCE	UNITS	mm
x.x ±0.30	SHEET SIZE	A4
x.xx ±0.20	Draw:	Daniel 2018-07-10
x.xxx ±0.10	Check:	Daniel 2018-07-10

NingBo KLS ELECTRONIC CO.,L TD.

1 RoHS Compliance

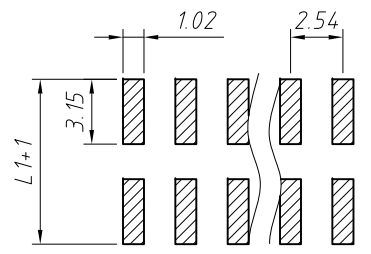
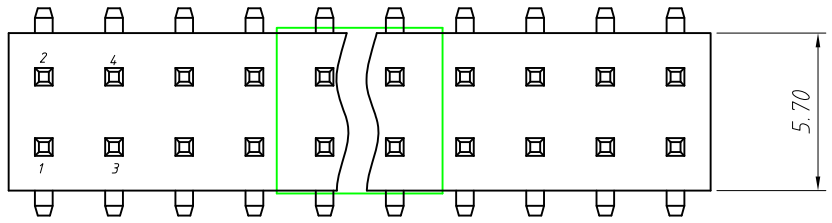

Recommended P.C.B Hole Layout

Material:
 Standard: PA6T, UL 94V-0
 Contact: Brass

Electrical Characteristics:
 Rated Current: 3AMP
 Contact Resistance: 20mΩ Max
 Withstand Voltage: 1000V AC/DC
 Insulator Resistance: 1000MΩ Min
 Withstanding Voltage: AC 500V

Mechanical
 Operating Temperature: -40°C ~ +105°C

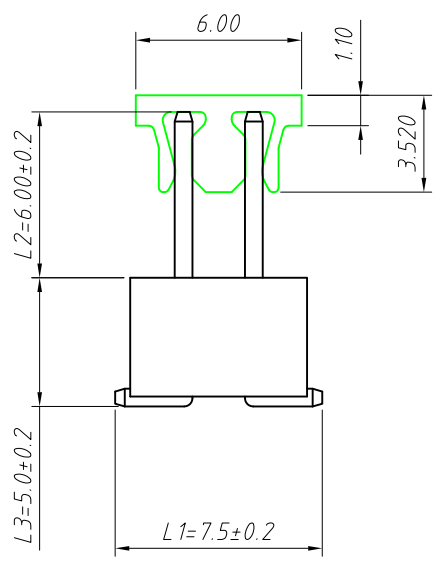
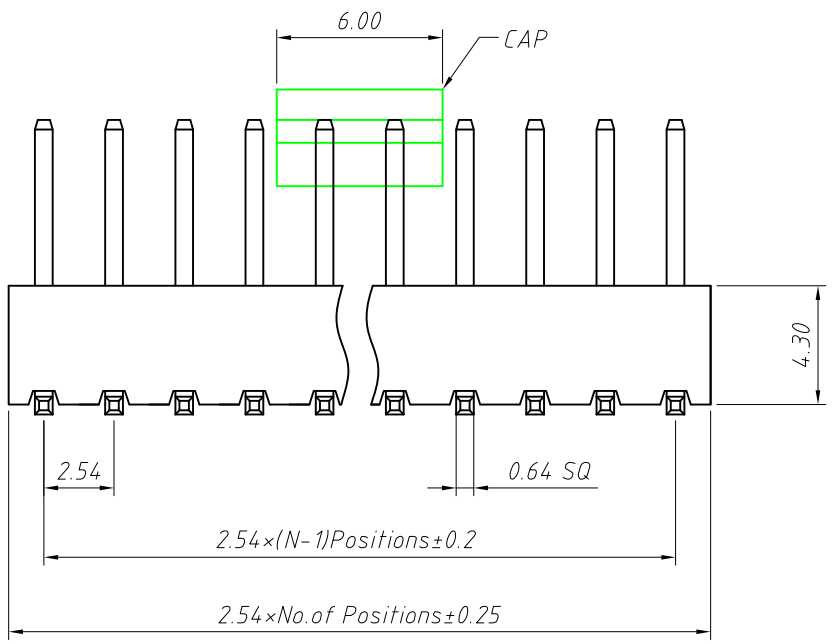

Order Information:
 L-KLS1-207L-2-XX-T-L1xL2xL3-G0-R

L: RoHS
 Pin Header Series
 207L: 2.54mm
 Per Row: Dual Row
 Pin: No. of Pins (02~80)
 Type: SMT Pin
 Size: L1xL2xL3
 Plating:
 G0=Gold Flash G1=1u" Gold G10=10u" Gold
 G15=15u" Gold G30=30u" Gold
 Packing:
 0=PE Bag A=Tray T=Tube
 P=Tube+Cap R=Reel+Cap

Dimension antitheses list (mm)				
ITEM	L1	L2	L3	Plastic Height
Standard	7.50	6.00	5.00	4.30
Nonstandard	---	---	---	---

ANGLE TOLERANCE	PROJECTION	Description:
±3°		2.54x4.3 Pin Header Dual Row, SMT Pin, 2xN Pin
GENERAL TOLERANCE	UNITS	mm
x.x ±0.30	SHEET SIZE	A4
x.xx ±0.20	Draw:	Daniel 2018-07-10
x.xxx ±0.10	Check:	Daniel 2018-07-10

KLS NingBo KLS ELECTRONIC CO.,LTD.