

RoHS Compliance

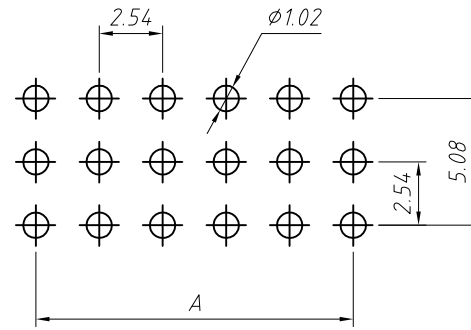
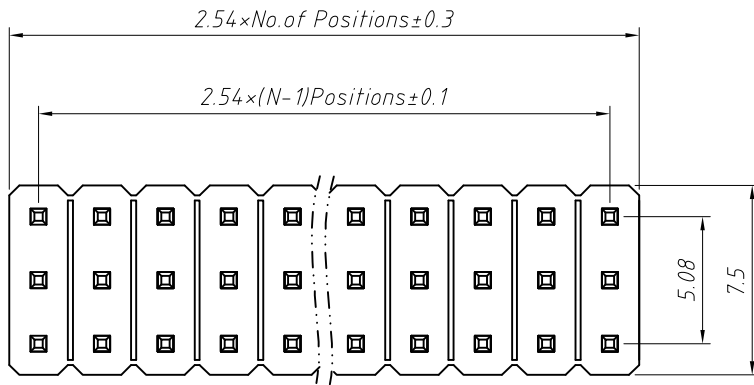

Recommended P.C.B Hole Layout

Material:
Standard: PA6T
Contact: Brass
Insulator: Polyester, UL94V-0

Electrical Characteristics:
Rated Current: 3AMP
Contact Resistance: 20mΩ Max
Withstand Voltage: 1000V AC/DC
Insulator Resistance: 1000MΩ Min

Mechanical
Operating Temperature: -40°C ~ +105°C

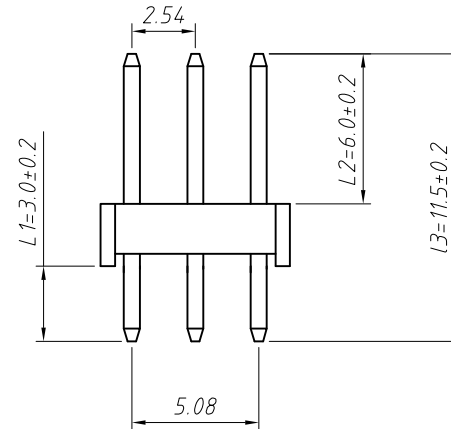
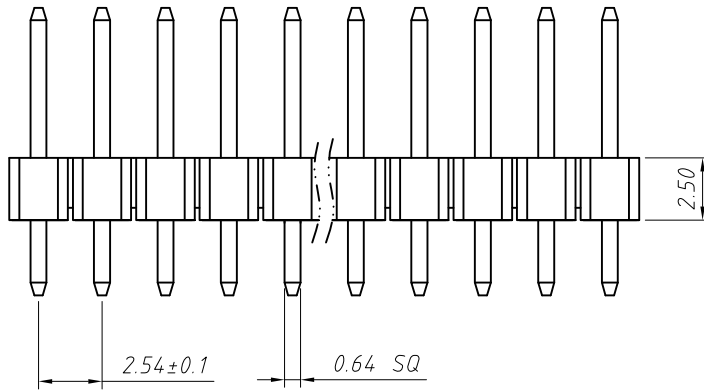

Order Information:
L-KLS1-207-3-XX-S-L1xL2xL3-G0

L: RoHS
Pin Header Series:
 207: 2.54mm
Per Row: Three layer
Pin No. of Pins (03 ~ 120)
Type: Straight Pin
Size: L1xL2xL3
Plating:
 G0=Gold Flash G1=1u" Gold
 G10=10u" Gold G15=15u" Gold
 G30=30u" Gold

| Dimension antitheses list (mm) | | | | |
|--------------------------------|-----|-----|------|----------------|
| ITEM | L1 | L2 | L3 | Plastic Height |
| Standard | 3.0 | 6.0 | 11.5 | 2.50 |
| Nonstandard | --- | --- | --- | --- |

| ANGLE TOLERANCE | PROJECTION | Description: |
|-------------------|------------|----------------------------------------------------------|
| ±3° | | 2.54x2.5Pin Header Three layer, Straight Pin, 3xN Pin |
| GENERAL TOLERANCE | UNITS | mm |
| x.x ±0.30 | SHEET SIZE | A4 |
| x.xx ±0.20 | Draw: | Daniel 2018-07-10 |
| x.xxx ±0.10 | Check: | Daniel 2018-07-10 |



NingBo KLS ELECTRONIC CO.,L TD.

RoHS Compliance

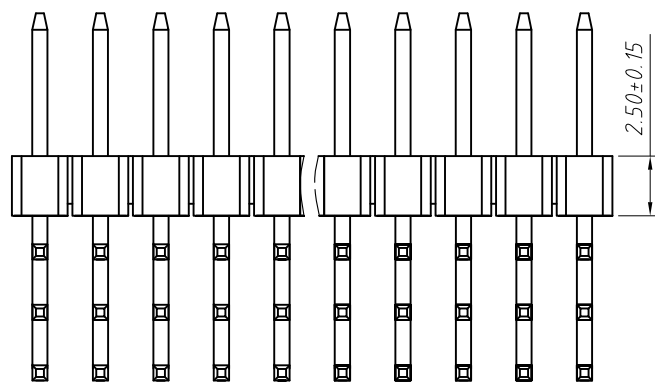
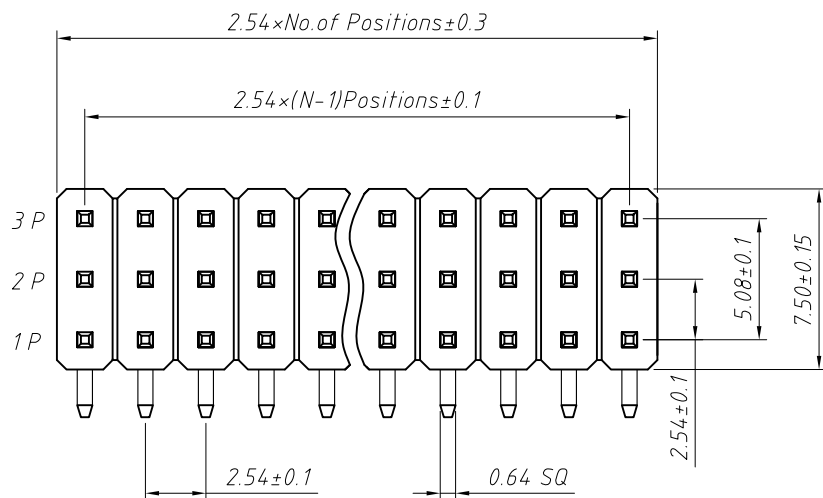

| Dimension antitheses list (mm) | | | | |
|--------------------------------|------|------|------|----------------|
| ITEM | L1 | L2 | L3 | Plastic Height |
| Standard | 3.00 | 6.00 | 1.20 | 2.50 |
| Nonstandard | --- | --- | --- | --- |

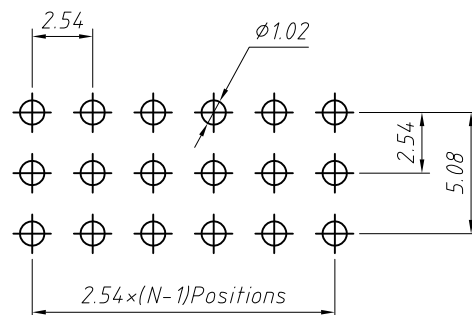

Recommended P.C.B Layout (Top Side)
(PCB BOARD TOLERANCE ± 0.05)

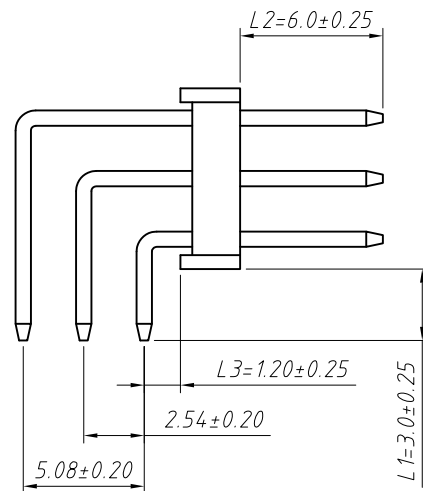

R1 Type

Material:
Standard: PA6T
Contact: Brass
Insulator: Polyester, UL94V-0

Electrical Characteristics:
Rated Current: 3AMP
Contact Resistance: 20mΩ Max
Withstand Voltage: 1000V AC/DC
Insulator Resistance: 1000MΩ Min

Mechanical
Operating Temperature: -40°C ~ +105°C
Max. Processing Temp: 230 for 30-60 seconds
(260°C for 5 seconds)

Order Information:
L-KLS1-207-3-XX-R1-L1xL2xL3-G0

L: RoHS
Pin Header Series
207: 2.54mm
Per Row: Three layer
Pin: No. of Pins (03 ~ 120)
Right angle Pin: R1 Type
Size: L1xL2xL3
Plating:
G0=Gold Flash G1=1u" Gold
G10=10u" Gold G15=15u" Gold
G30=30u" Gold

| ANGLE TOLERANCE | PROJECTION | Description: | 2.54x2.5 Pin Header | | |
|-------------------|------------|---------------------------------------|----------------------------------|--------------------------------|------------|
| ±3° | | Three layer, Right angle Pin, 3xN Pin | | | |
| GENERAL TOLERANCE | UNITS | mm | KLS P/N: | L-KLS1-207-3-XX-R1-L1xL2xL3-G0 | |
| x.x ±0.30 | SHEET SIZE | A4 | NingBo KLS ELECTRONIC CO., L TD. | | |
| x.xx ±0.20 | Draw: | Daniel | | | 2018-07-10 |
| x.xxx ±0.10 | Check: | Daniel | | | 2018-07-10 |