

1  
RoHS Compliance

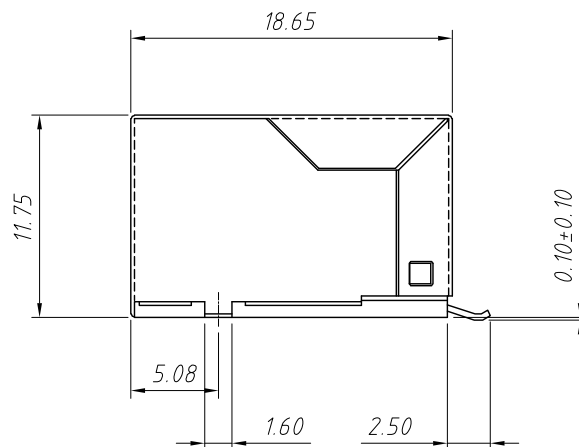

P.C.B Layout (Top View)

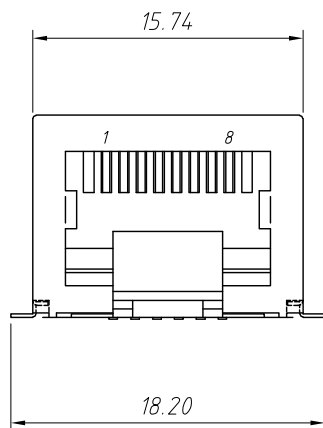
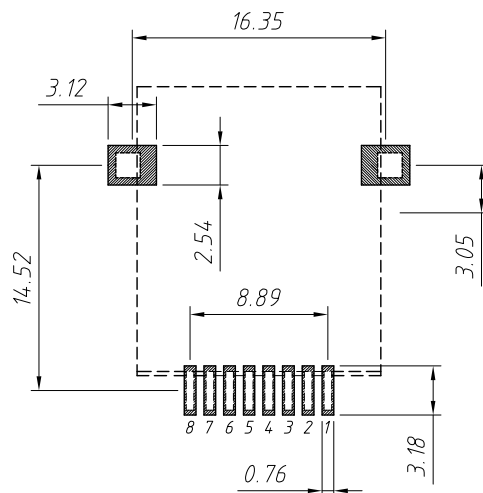
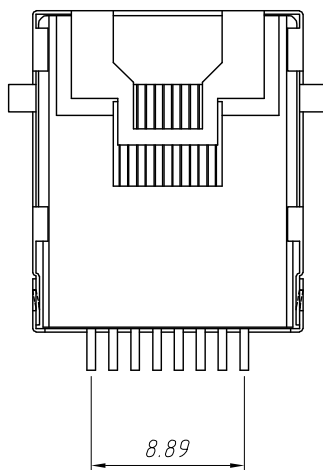

**Electrical:**

- 1.Voltage Rating:125VAC
- 2.Current Rating:1.5A
- 3.Contact Resistance:40mΩ Max.
- 4.Insulation Resistance:1000MΩ Min.@500VDC
- 5.Withstanding Resistance:1000VAC RMS.50Hz 1minute

**Materials:**

- 1.Housing:High Temp. Thermoplastic Flammability,UL 94 V-0
- 2.Contact: Phosphor Bronze
- 3.Plating:Gold Plating over nickel in contact,  
Tin Planting over nickel in solder area
- 4.Shield:0.23 Thickness Brass With Nickel Plated

**Mechanical:**

- 1.Durability:750 cycles Min.
- 2.PCB Retention pre-solder:1 LB Min.

**Environmental:**

1. Storage:-40°C ~ +85°C
2. Operation:-40°C ~ +75°C

**Order Information:**

L-KLS12-SMT10-8P8C-W-XX-P

- L: RoHS
- SMT series
- Point No:8P8C
- Shield Code:W-With Shield
- Plating:
  - 01:Fu"Gold 02:3u"Gold 03:6u"Gold
  - 04:15u"Gold 05:30u"Gold
- Packing:R-Reel P-Blister Tray

ANGLE TOLERANCE	PROJECTION	Description:	RJ45-8P8C SMD Jack Horizontal, With Shielded
±3°			
GENERAL TOLERANCE	UNITS	mm	KLS P/N: L-KLS12-SMT10-8P8C-W-XX-P
x.x ±0.30	SHEET SIZE	A4	NingBo KLS ELECTRONIC CO.,L TD.
x.xx ±0.20	Draw:Jenny	Daniel	
x.xxx ±0.10	Check:Daniel	Daniel	
		2021-08-01	
		2021-08-01	