

Technical parameters:

1. Characteristic impedance of joint: 50mΩ
2. Joint surface: gold plating
3. Usage frequency: 0-6GHz
4. Mechanical demand: 500 times

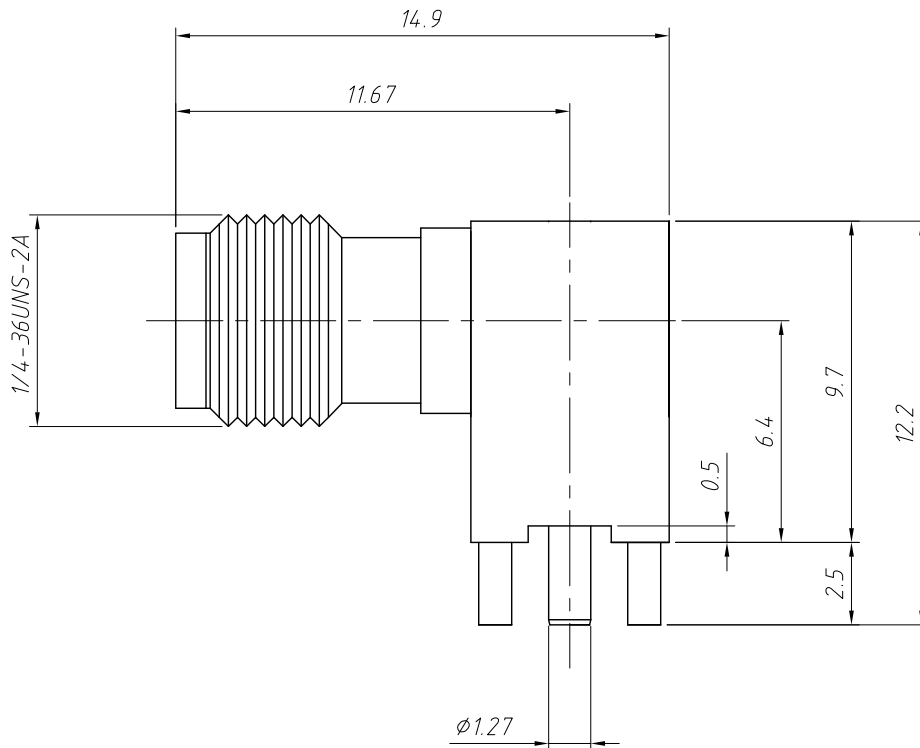

Order Information

L - KLS1 - SMA257

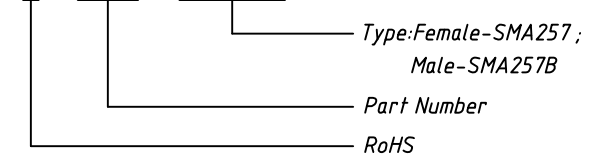

GENERAL TOLERANCE	PROJECTION		Description:
.X ±0.50	UNITS	mm	PCB Mount SMA Connector Right Angle (Jack, Female & Male, 50Ω) L14.9mm
.X ±0.25	SCALE	1:1	
.XX ±0.10	Draw by:	Jenny	KLS P/N: L-KLS1-SMA257 & L-KLS1-SMA257B
ANGLE TOLERANCE	Check by:		NingBo KLS ELECTRONIC CO.,L TD.
.X ±5°	Date	2018-03-01	
.X ±3°	SHEET	1 OF 1	
.XX ±2°			