

RECOMMENDED PCB LAYOUT
TOL:±0.05

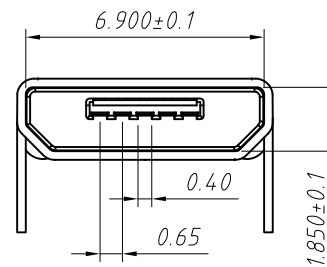

Material

Housing:Hing Temperature Thermoplastics,UL 94 V-0 LCP,Black.
Contact:Copper Alloy C5191.
Shell:Copper Alloy C2680.

Finish:

Contact:Plated Gold In Mating Area; Tin On Solder Talls.
Shell:Nickel Plating.

Electrical:

Current Rating:1.0A/Contact Terminal.
Voltage Rating:30V DC
Contact Resistance:50mΩ Max.
Dielectric Withstanding Voltage:300 V AC AT Sea Level.
Insulation Resistance:100MΩ Min.
Connector Mate and Unmated Force
Mate Force:3.0kgf Max.
Unmated Force:0.7kgf Min.
Terminal Retention:0.5kgf Min.

Order Information

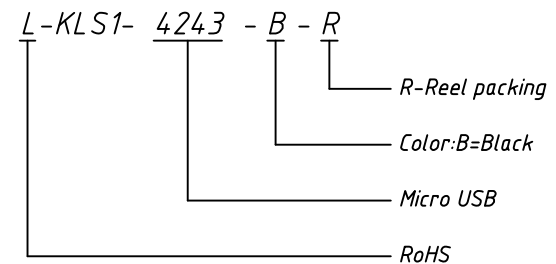

GENERAL TOLERANCE	PROJECTION		Description:
X. ±0.50	UNITS	mm	CONN RCPT 5POS MICRO USB SMD
.X ±0.25	SCALE	1:1	
.XX ±0.10	Draw by:	Jenny	
ANGLE TOLERANCE	Check by:		KLS P/N: L-KLS1-4243-B-R
X. ±5°	Date	2018-03-01	NingBo KLS ELECTRONIC CO.,L TD.
.X ±3°	SHEET	1 OF 1	
.XX ±2°			