

Cable Insert Dim

Proper Cable

Material
 Housing: Thermoplastic, UL 94 V-0
 Actuator: Thermoplastic, UL 94 V-0
 Terminal: Phosphor Bronze
 Fitting Nail: Brass

Electrical
 Voltage rating: 50 V
 Current rating: 0.5 A
 Withstand Voltage: 500 V
 Insulation resistance: 500MΩ.Min.
 Contact resistance: 30 mΩ.max.

Mechanical
 Temp. Range: $-25^{\circ}C \sim +85^{\circ}C$

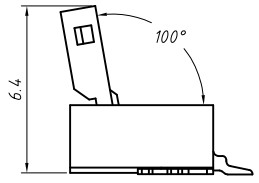
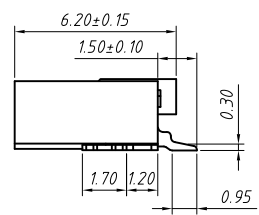
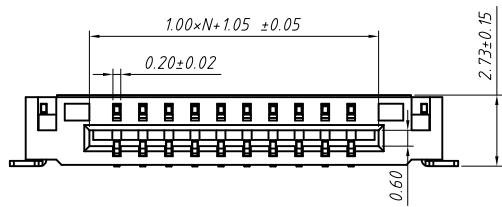

Order Information

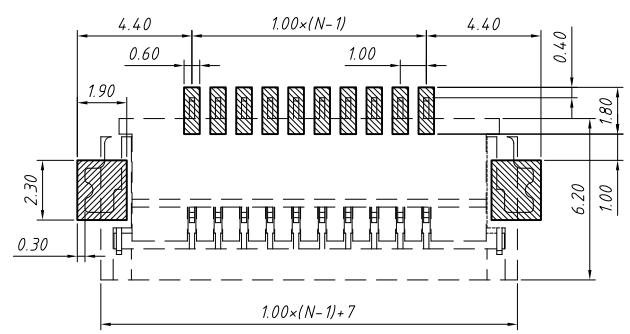
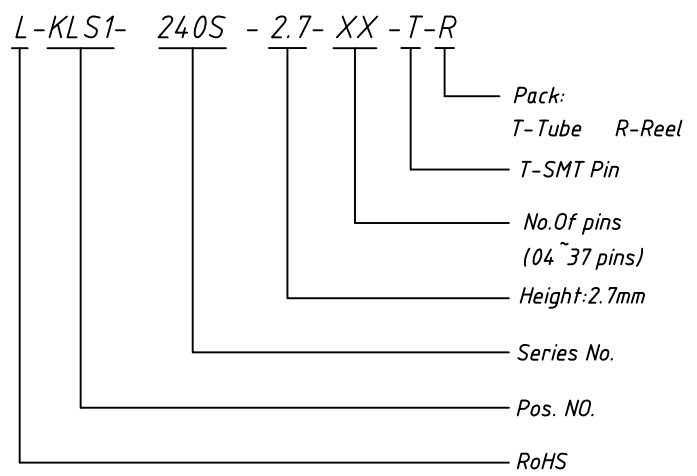

PCB LAYOUT

GENERAL TOLERANCE	ANGLE TOLERANCE	PROJECTION	Description:
X. ± 0.15	X. $\pm 5^{\circ}$	UNITS	CONN FFC 1.00mm, SMD, Horizontal, with ZIF
.X ± 0.03	.X $\pm 3^{\circ}$	SHEET SIZE	
.XX ± 0.05	.XX $\pm 2^{\circ}$	KLS P/N:	

Draw by: Date	2018-03-10
Check by: Date	2018-03-10
SCALE	SHEET OF

NingBo KLS ELECTRONIC CO.,LTD.