

PCB Layout

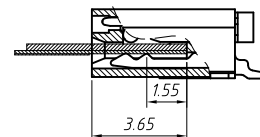

CABLE INSERT DIM.

Material

Housing:HIGH-TEMP Thermoplastic, UL94V-0
 Actuator:HIGH-TEMP Thermoplastic, UL94V-0
 Terminal:Phosphor bronze ,Gold/Tin
 Fitting nail:Brass,Matte-Tin or Tin

Electrical

Voltage rating: 50 V
 Insulation resistance: 500 MΩ.Min.
 Contact resistance: 30 mΩ.Max.

Mechanical

Temp. Range: -25 °C ~ + 85 °C

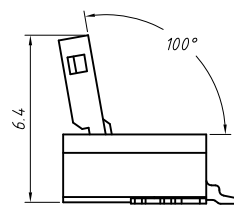
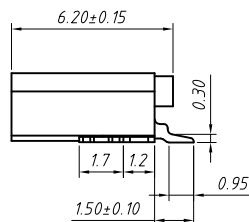
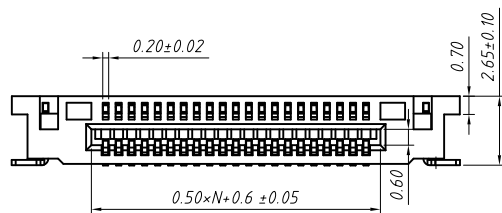

Order Information

L-KLS1- 242Q - 2.6- XX -T-R

- Pack:
 - T-Tube R-Reel
 - T-SMT Pin
- No.Of pins
(04 ~ 61 pins)
- Height:2.60mm
- Series No.
- Pos. NO.
- RoHS

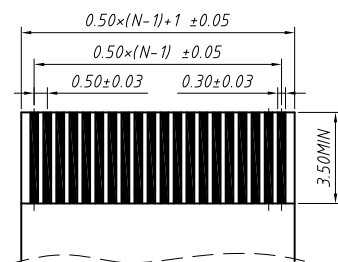

Proper Cable

GENERAL TOLERANCE	ANGLE TOLERANCE	PROJECTION	Description:
X. ±0.15	X. ±5°	UNITS	CONN FFC 0.50mm,SMD,Horizontal,with ZIF
.X ±0.03	.X ±3°	SHEET SIZE	
.XX ±0.05	.XX ±2°	KLS P/N:	

Draw by: Date	2018-03-10
Check by: Date	2018-03-10
SCALE	SHEET OF



NingBo KLS ELECTRONIC CO.,L TD.