

1 RoHS Compliance

Material:

Housing: 30% Glass filled PBT UL94V-0

Contacts: Phosphor Bronze

Plating: Au or Sn over 50u" nickel

Electrical Characteristics:

Current Rating: 3.0 AMP

Voltage rating: 250V AC, DC

Withstand Voltage: 500V AC

Insulator Resistance: 1000M Ohm min

Contact Resistance: 20m Ohm max.

Operating Temperature: -40°C ~ +105°C

Max. Processing Temp: 180°C for 30-60 seconds
(200°C for 10 seconds)

Pin	Dimension mm	
	A	B
10	10.16	22.36
14	15.24	27.44
16	17.78	29.98
20	22.86	35.06
26	30.48	42.68
34	40.64	52.84
40	48.26	60.46
50	60.96	73.16
60	73.66	85.86
64	78.74	90.94

Order Information:

L-KLS1-204CE-XX

L: RoHS

IDC connectors

2.54mm Pitch

XX-No. of 10 ~ 64pin

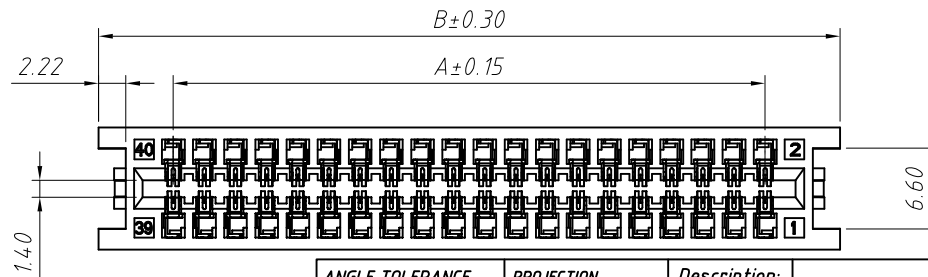
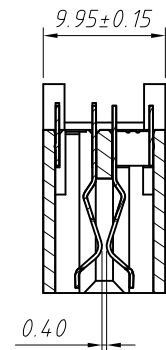
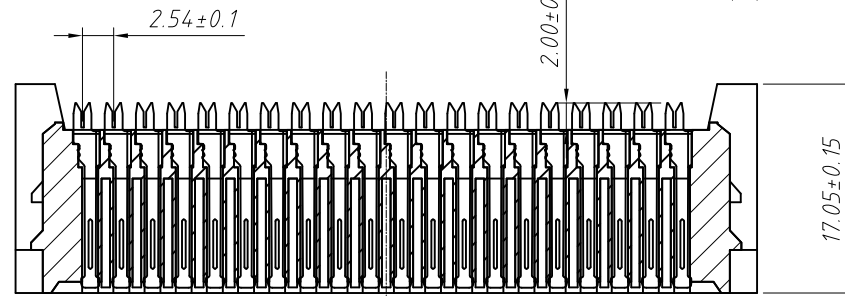
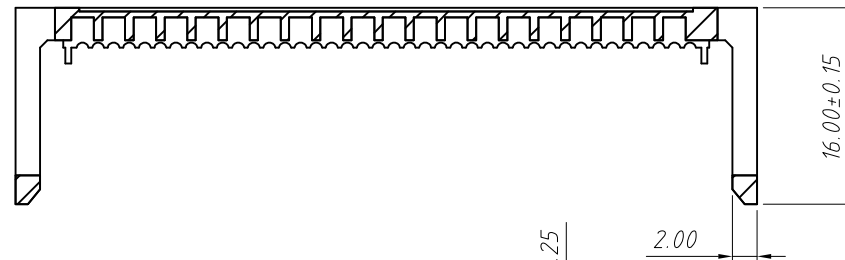
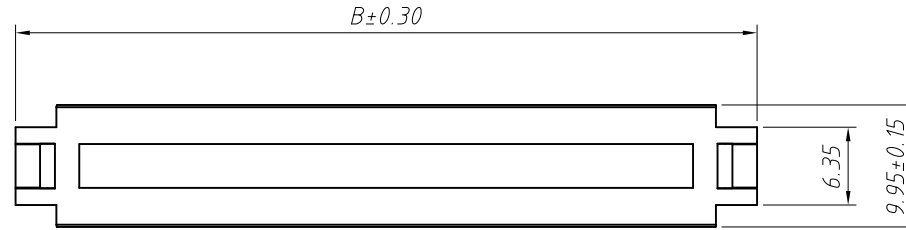
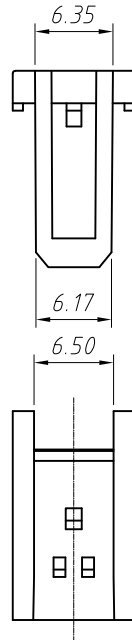

ANGLE TOLERANCE		PROJECTION		Description:	
±3°				2.54mm Pitch EDGE Card IDC Connector	
GENERAL TOLERANCE		UNITS	mm	KLS P/N:	
x.x ±0.30		SHEET SIZE		A4	
x.xx ±0.20		Draw:		Daniel 2018-07-10	
x.xxx ±0.10		Check:		Daniel 2018-07-10	
				L-KLS1-204CE-XX	



NingBo KLS ELECTRONIC CO.,LTD.