

IEEE 1394 Series

KLS1-1394-6FD IEEE 1394 6 Pin Plug Solder For Cable Ass'Y

Material:

Housing: Thermoplastic, UL94V-0
Contact: Copper Alloy
Shell: Copper Alloy
Pin Plated: Gold 3u" over 50u" nickel

Electrical Characteristics:

Voltage Current Rating: 1.5AMP.40V AC
Insulation Resistance: 500MΩ Min
Contact Resistance: 50mΩ Max
Dielectric Withstanding Voltage: 500V AC
Temperature Range: -20°C ~+85°C

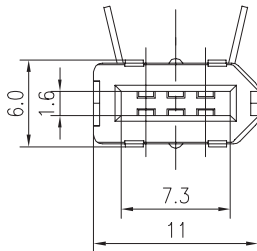

NO.	P/N	QTY	Material
1	UP Shield	1	H65Y
2	insert	1	PBT
3	Terminal	6	Qsn6. 5-0. 1
4	Doen Shield	1	H65Y

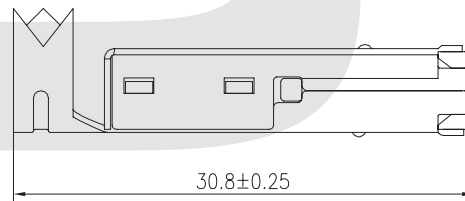
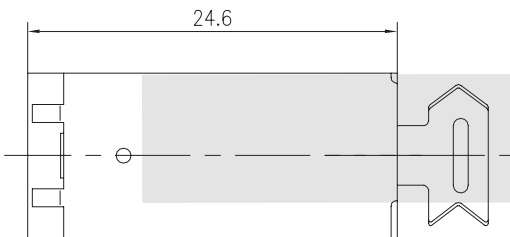

ORDER INFORMATION

Product NO.: KLS1 - 1394-6FD-B

Pos. NO. _____
IEEE 1394 TYPE _____

Color: W=WHITE B=BLACK