

**Material**  
 Housing: High Temperature Thermoplastics,  
 UL 94V-0 LCP, Black.  
 Contact: C2680/C5191.  
 Shell: Steel.

**Finish:**  
 Contact: Plated Gold In Mating Area;  
 Tin Lead On Solder Tails.  
 Shell: Tin Lead Plating.

**Electrical:**  
 Contact Resistance: 30mΩ Max.  
 Dielectric Withstanding Voltage:  
 50 V AC AT Sea Level.  
 Insulation Resistance: 100MΩ Min.

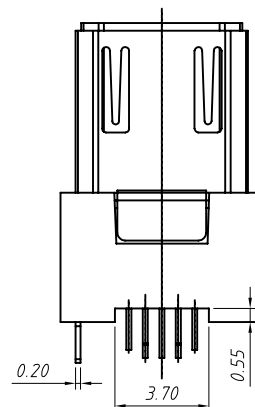
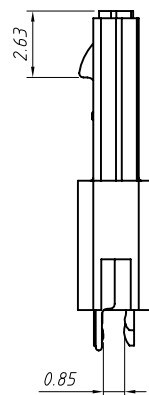
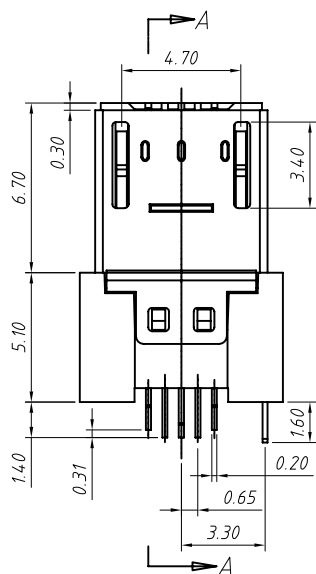

GENERAL TOLERANCE	PROJECTION		Description:
.X ±0.50	UNITS	mm	CONN PLUG MICRO USB TYPE B CLIP
.X ±0.25	SCALE	1:1	
.XX ±0.10	Draw by:	Jenny	
ANGLE TOLERANCE	Check by:		KLS P/N: L-KLS1-236-5M8-B
.X ±5°	Date	2018-03-01	NingBo KLS ELECTRONIC CO.,L TD.
.X ±3°	SHEET	1 OF 1	
.XX ±2°			