

RECOMMENDED PCB LAYOUT
GENERAL TOLERANCES: ±0.05

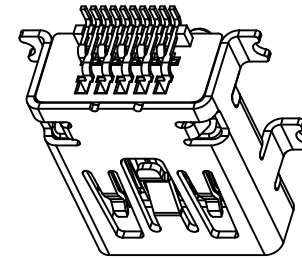

Material
Housing: THERMOPLASTIC, UL94V-0
Shield: Copper alloy, Tin plated
Terminal: Copper alloy, Contact: Au Plated

Electrical
Insulator Resistance: 1000MΩ Min
Contact Resistance: 80mΩ Max
Withstanding Voltage: 500V AC 1 minute

Order Information

L-KLS1- 229 - 10FA-B
 Color: B=Black
 Serial number
 Model
 RoHS

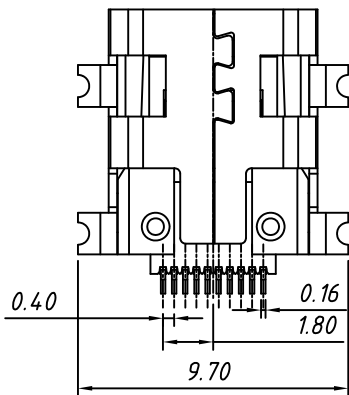
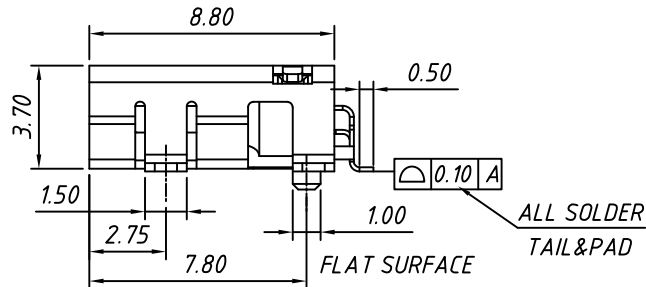
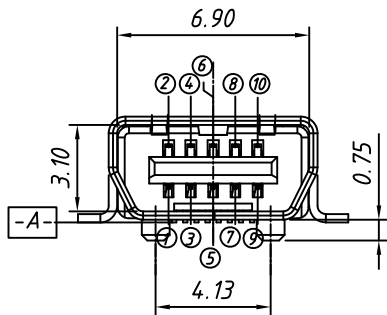

GENERAL TOLERANCE	PROJECTION		Description:
X. ±0.30	UNITS	mm	MINI USB 0.4mm 10P Female SMT
.X ±0.25	SCALE	1:1	
.XX ±0.20	Draw by:	Jenny	KLS P/N: L-KLS1-229-10FA-B-R
ANGLE TOLERANCE	Check by:		NingBo KLS ELECTRONIC CO.,L TD.
X. ±3°	Date	2018-03-01	
.X ±2°	SHEET	1 OF 1	
.XX ±1°			