

1  
RoHS Compliant

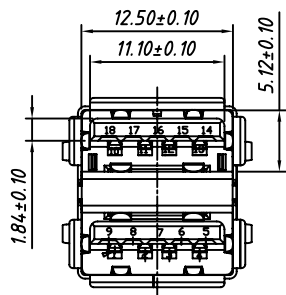

$\phi 0.70 \pm 0.05$   
 $\phi 1.10 \pm 0.05$

$\phi 2.30 \pm 0.10$   
 $\phi 2.90 \pm 0.10$

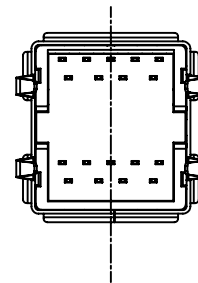
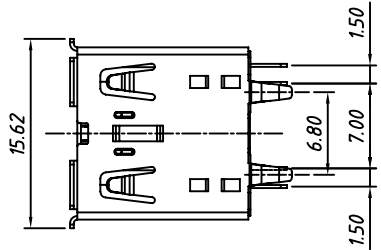
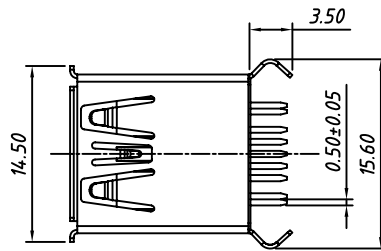
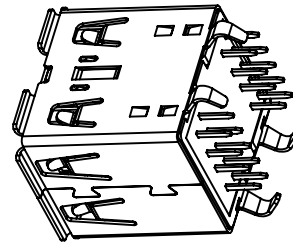
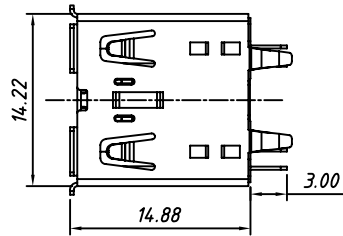
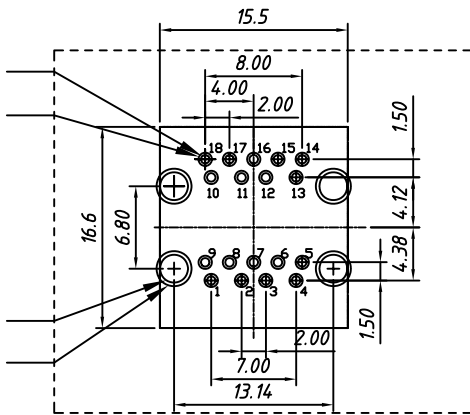

RECOMMENDED PCB LAYOUT  
TOLERANCE:  $\pm 0.05$ ,

Material

Housing: Thermoplastic, Glass Fiber Filled, UL 94-HB  
Cover: Thermoplastic, Glass Fiber Filled, UL 94V-0  
Contact: Copper Alloy, Gold.  
Shell: Brass/Spcc, Nickel(Ni) T=0.30MM

Electrical

Contact Current Rating: 1.5 A For Pin1&Pin4  
0.25 A Other Contacts.

Withstanding Voltage: 100vac(Rms)

Contact Resistance: 30mΩ Max(Initial) For Pin1&Pin4  
50mΩ Max(Initial) For Other Contacts

Insulation Resistance: 1000MΩ Min

Mechanical

Operating Temperature: -30°C TO +80°C.

Mating Force: 35N MAX

Unmating Force: 10N MIN.

Order Information

L-KLS1- 3009 - L

Color: L:Blue

USB 3.0 Type A Female

RoHS

GENERAL TOLERANCE	PROJECTION		Description:
X. $\pm 0.50$	UNITS	mm	USB 3.0 Type A Female CONN, Double, Straight DIP
.X $\pm 0.25$	SCALE	1:1	
.XX $\pm 0.10$	Draw by:	Jenny	
ANGLE TOLERANCE	Check by:		KLS P/N: KLS1-3009
X. $\pm 5^\circ$	Date	2018-03-01	NingBo KLS ELECTRONIC CO.,L TD.
.X $\pm 3^\circ$	SHEET	1 OF 1	
.XX $\pm 2^\circ$			