

Recommended PCB Layout
GFNFRAL TOLERANCE ±0.05

PAD AREA

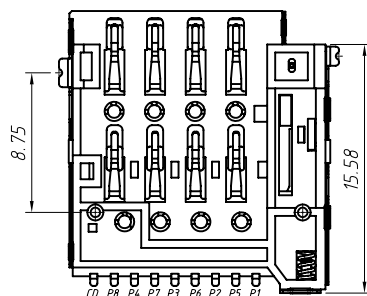
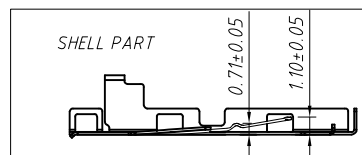
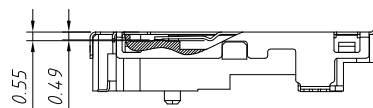
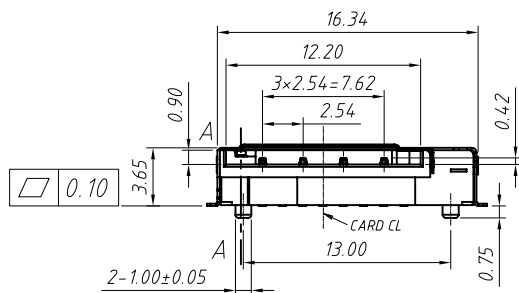
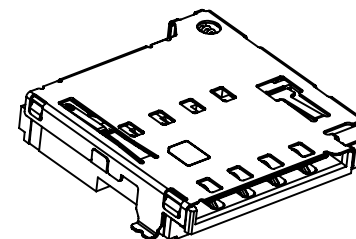

Material:
 Housing: High Temperature Thermoplastic, UL 94 V-0, Black.
 Terminal: Copper Alloy. Contact Au: G.F Plating
 Shell: Stainless Steel. Slider Plating Au: 1u", Ni: 30u" Min.

Electrical:
 Current Rating: 1.0A
 Rating Voltage: 50V
 Contact Resistance: 100mΩ Max.
 Insulation Resistance: 1000MΩ Min./500V DC
 Dielectric Withstanding Voltage: 500V AC
 Solder ability: 255±5° C, 5±5S
 Humidity: 80% R.H. Max.
 Durability: 5000 Cycles Min.
 Operating condition: Temperature -40° C ~ +85° C

GENERAL TOLERANCE		ANGLE TOLERANCE		PROJECTION		Description: Micro SIM CONN; PUSH/ PUSH, 8Pin, H3.65mm, with CD Pin L-KLS1-SIM-096-H3.65-R
X	±0.15	X	±5°	UNITS	mm	
.X	±0.03	.X	±3°	SHEET SIZE	A4	
.XX	±0.05	.XX	±2°	KLS P/N:		

Draw by:	Jenny	Date:	2018-03-10
Check by:		Date:	2018-03-10
SCALE		SHEET	1 OF 1



NingBo KLS ELECTRONIC CO., L TD.