

Material:

Housing: Thermoplastic, UL 94 V-0, White.
 Contact: Copper Alloy 0.40T, Gold Flash On Contact Area Matte-Tin plated on solder tail all over Nickel plated.
 Fixing: Copper Alloy 0.30T, Tin plated on solder tail all over Nickel plated.

Electrical:

Current Rating: 0.5A AC, DC.
 Contact Resistance: 40mΩ Max.
 Insulation Resistance: 1000MΩ Min.
 Withstanding Voltage: 500V AC/minute
 Temperature Range: -40°C ~ +85°C.

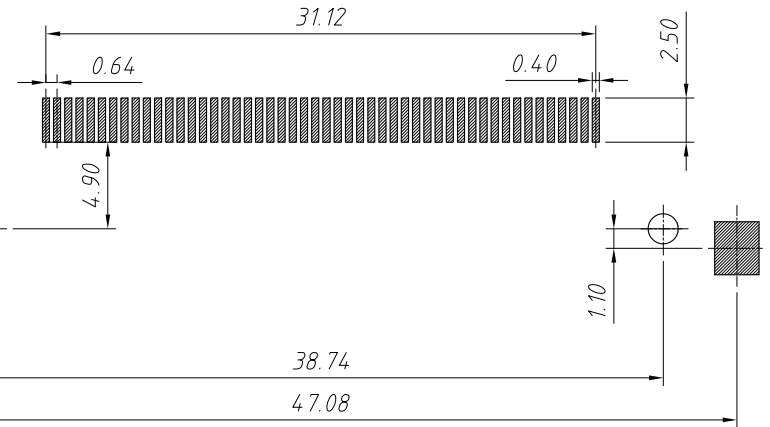

RECOMMENDED PCB LAYOUT
 GENERAL TOLERANCE ±0.05

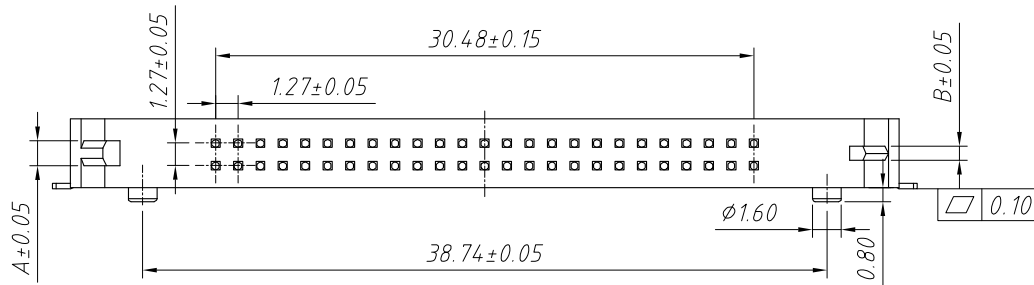

MODEL	DIM.A	DIM.B
L-KLS1-CF-003-A	1.35	0.70
L-KLS1-CF-003-B	0.70	1.35

GENERAL TOLERANCE		ANGLE TOLERANCE		PROJECTION		Description:	
.X	±0.15	.X	±5°	UNITS	mm	CF CARD CONN, L 13.75mm, H 3.9mm	
.X	±0.03	.X	±3°	SHEET SIZE	A4		
.XX	±0.05	.XX	±2°	KLS P/N:			
Draw by:	Jenny	Date:	2018-03-10	 NingBo KLS ELECTRONIC CO., L TD.		L-KLS1-CF-003	
Check by:		Date:	2018-03-10				
SCALE		SHEET	1 OF 1				