

**Material**

Pin header: Phosphor Bronze, Tin plated

Housing: PA66, UL 94V-0

**Electrical**

Rated voltage: 300V

Rated current: 15A

Contact Resistance: 20 mΩ

Insulation resistance: 500MΩ/DC500V

Withstand voltage: AC2000V / 1 min

**Mechanical**

Temp. Range:  $-40^{\circ}\text{C} \sim +105^{\circ}\text{C}$

Soldering: 250°C 5Sec. Max.

SECTION

**Order Information**

L-KLS2-EDKH-5.08-XXP-4 XX

RoHS

Terminal Block

Pitch

No. of Pole

Color: 4- Green

Product Code: 00~99

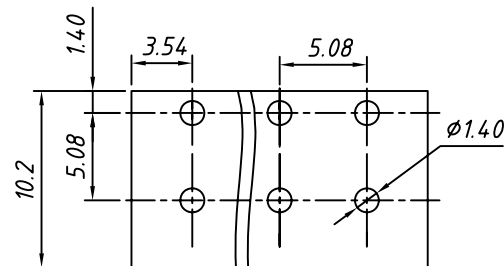
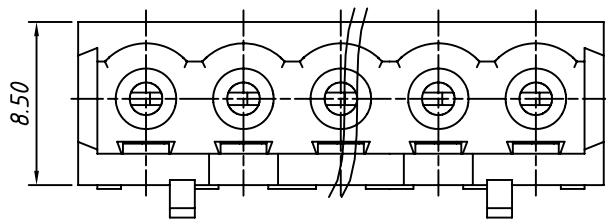

PCB LAYOUT

GENERAL TOLERANCE	ANGLE TOLERANCE	PROJECTION	Description:
X. $\pm 0.60$	X. $\pm 5^{\circ}$	UNITS	Plug-in TERM BLOCK 5.08MM
.X $\pm 0.38$	.X $\pm 3^{\circ}$	SHEET SIZE	
.XX $\pm 0.25$	.XX $\pm 2^{\circ}$	KLS P/N:	KLS2-EDKH-5.08-XXP-4

Draw by: Date	2015-09-01
Check by: Date	2015-09-15
SCALE	SHEET OF

KLS ELECTRONIC CO., LTD.