

Material
 Screw: M3, Steel, Zn plated
 Shrapnel: Stainless steel, Nickel plated
 Pin header: Brass, Tin plated
 Housing: PA66, UL94V-0

Electrical

Rated voltage: 300V
 Rated current: 15A
 Wire range: 26~14AWG 2.5mm²
 Contact Resistance: 20 mΩ
 Insulation resistance: 500MΩ/DC500V
 Withstand voltage: AC2000V / 1min

Mechanical

Temp. Range: -40 °C ~ +105 °C
 Soldering: 250 °C±5 °C for 5S
 Torque: 0.5 Nm (4.43Lb. in)
 Strip length: 6~7 mm

Order Information

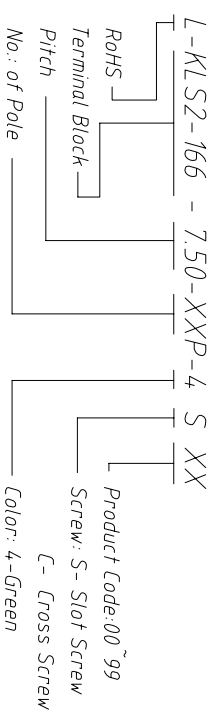

SECTION A-A

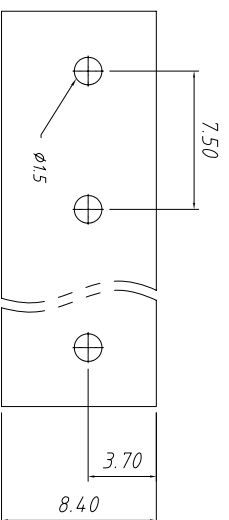

PCB LAYOUT

GENERAL TOLERANCE		ANGLE TOLERANCE		PROJECTION		Description:	
X: ±0.60	X: ±0.38	XX: ±0.25	X: ±5°	X: ±3°	XX: ±2°		UNITS
Draw By: Date		2015-09-01		KLS P/N:		KLS2-166-7.50-XXP-4S	
Check By: Date		2015-09-15		SCALE		SHEET	
SCALE		SHEET		OF		KLS ELECTRONIC CO., LTD.	

KLS ELECTRONIC CO., LTD.