

PCB LAYOUT

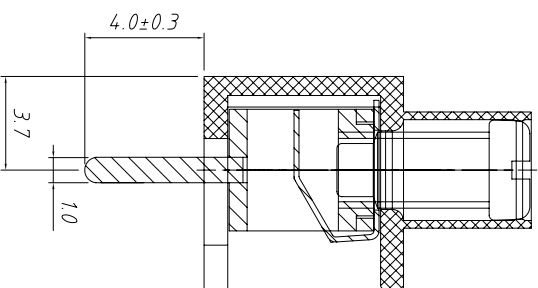

SECTION A-A

Material
 Screw: M3, Steel, Zn plated
 Shrapnel: Stainless steel, Nickel plated
 Pin header: Brass, Tin plated
 Housing: PA66, UL94V-0

Electrical
 Rated voltage: 300V
 Rated current: 15A
 Wire range: 26~14AWG 2.5mm²
 Contact Resistance: 20 mΩ
 Insulation resistance: 500MΩ/DC500V
 Withstand voltage: AC2000V / 1min

Mechanical
 Temp. Range: -40 °C ~ +105 °C
 Soldering: 250 °C ±5 °C for 5S
 Torque: 0.5 Nm (4.43lb. in)
 Strip length: 6 ~ 7 mm

Order Information

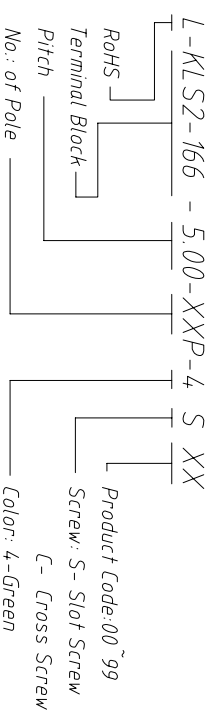

GENERAL TOLERANCE		ANGLE TOLERANCE		PROJECTION		Description:
X: ±0.60	X: ±0.38	XX: ±0.25	X: ±5°	X: ±3°	XX: ±2°	
Draw By: Date	2015-09-01	SHEET		OF		KLS ELECTRONIC CO., LTD.
Check By: Date	2015-09-15	SHEET		OF		
SCALE		SHEET		OF		

