

SECTION A-A

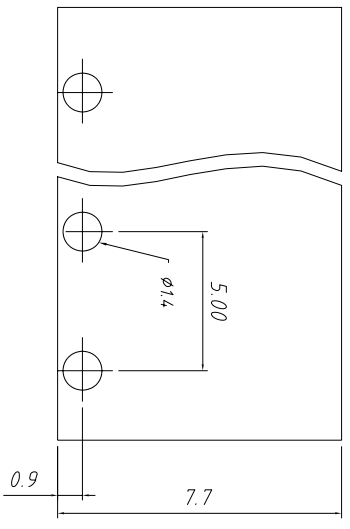

PCB LAYOUT

Material
 Screw: M2.5, Steel, Zn plated
 Shrapnel: Stainless steel, Nickel plated
 Pin header: Brass or Steel, Tin plated
 Housing: PA66, UL94V-0

Electrical
 Rated voltage: 300V
 Rated current: 8A
 Wire range: 26~14AWG 2.5mm²
 Contact Resistance: 20 mΩ
 Insulation resistance: 500MΩ/DC500V
 Withstand voltage: AC2000V / 1min

Mechanical
 Temp. Range: -40 °C ~ +105 °C
 Soldering: 250 °C ±5 °C for SS
 Torque: 0.4 N.m (3.54Lb. in)
 Strip length: 6 ~ 7 mm

Order Information

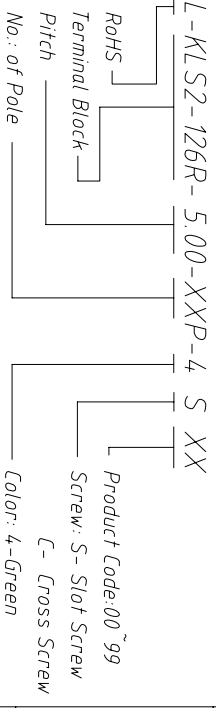

GENERAL TOLERANCE		ANGLE TOLERANCE		PROJECTION		Description:
X: ±0.60	X: ±0.38	XX ±0.25	X: ±5°	X: ±3°	XX ±2°	
Draw By: Date	2015-09-01	Check By: Date	2015-09-15	SCALE	SHEET	OF
				UNITS		mm
				SHEET SIZE		A4
				KLS P/N:		KLS2-126R-5.00-XXP-4S
Screw CONN TERM BLOCK 5.00MM						

KLS ELECTRONIC CO., LTD.