

SPECIFICATION:

Circuit: Push (ON)

Current Rating: 30mA

Voltage Rating: 30V DC

Dielectric Strength: 500VAC / 1 minute

Contact Resistance: 100mΩ Max.

Operating Force: 200±50gf

Total Travel: 0.7±0.2mm

Life: 100,000 cycles Min.

Operating temperature: +10°C~+60°C

Cap Color				
CODE :	R	Y	G	B
Color:	Red	Yellow	Green	Black
				Blue

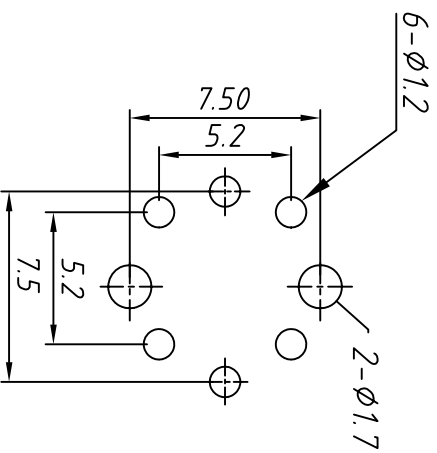

PCB LAYOUT

GENERAL	X	*0.30	UNITS:	mm	Description:	12mm Reset Tact Switch
TOLERANCE	.XX	*0.15	Size:	A4	Item code:	KLST-TSS1201-X
ANGLE TOLERANCE		±1°	Draw by:			
PROJECTION	⊕		Check by:			

KLS ELECTRONIC CO., LTD.