

## SFP\*XFP\*QSFP/QSFP+ Connectors

KLS1-SFP-020

### Electrical Specifications:

CURRENT: 0.50 A PER CONTACT.  
 CONTACT RESISTANCE:50 MILLIOHMS MAX;  
 INSULATION RESISTANCE:1000 MEGAOHMS MIN  
 AT 100 VDC FOR 1 MINUTE.  
 DIELECTRIC WITHSTANDING VOLTAGE:300 VDC MIN;  
 TEMPERATURE:  
 OPERATION: -40°C~+85°C  
 STORAGE: -40°C~+85°C  
 LIGHTPIPE PAD LAYOUT IS FOR LOW-PROFILE LED PACKAGE.  
 LED SIZE(LxWxH): 2x1x0.4MM MAX. RoHS COMPLIANCE.

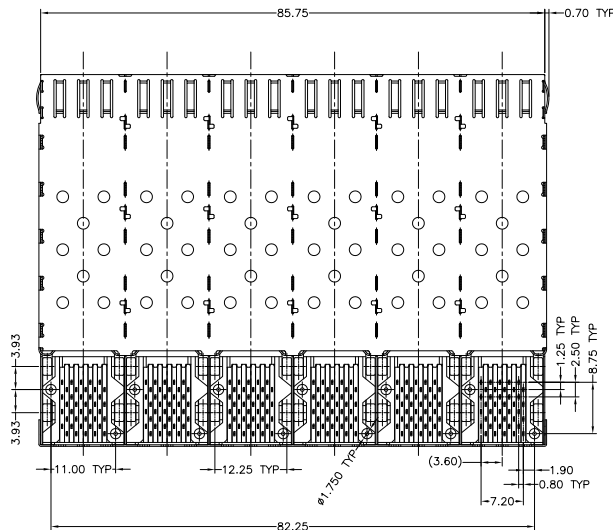
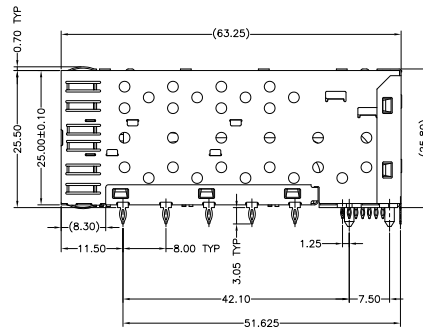
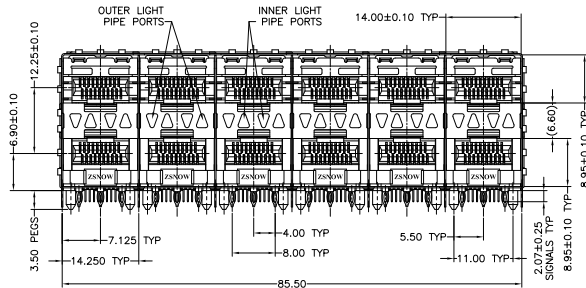
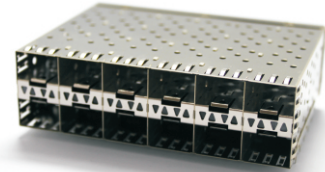

**MECHANICAL:**  
 CAGES: NICKEL SILVER ALLOY, THICKNESS 0.25MM.  
 CONNECTOR HOUSING: GLASS FILLED PLASTIC, 94 V-0, COLOR: BLACK.  
 OVERMOLDED TERMINAL HOUSING: GLASS FILLED PLASTIC, 94 V-0, COLOR: BLACK.  
 LIGHTPIPES: POLYCARBONITE, 94 V-0, COLOR: CLEAR.  
 LIGHTPIPE HOLDER: GLASS FILLED PLASTIC, 94 V-0, COLOR: BLACK.  
 CLIP: STAINLESS STEEL.  
 TERMINAL: POSPHRR BRONZE.  
 GOLD PLATING FOR CONTACT AREA, THICKNESS SEE OPTION.  
 TIN PLATING FOR PRESS FIT AREA.  
 NICKEL PLATING AS UNDERLAYER FOR WHOLE TERMINAL.

## ORDER INFORMATION

KLS1-SFP-020

Part Number

## SFP\*XFP\*QSFP/QSFP+ Connectors

KLS1-SFP-020

XII

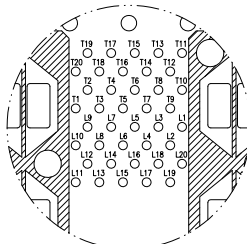
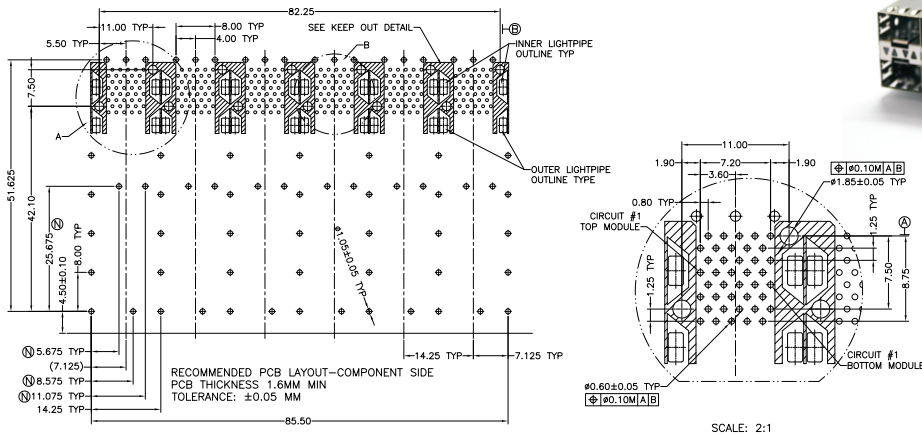
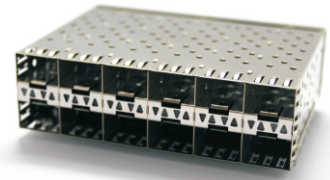

CONNECTOR PIN-OUT DETAIL  
COMPONENT SIDE OF BOARD  
DETAIL B  
SCALE: 2:1

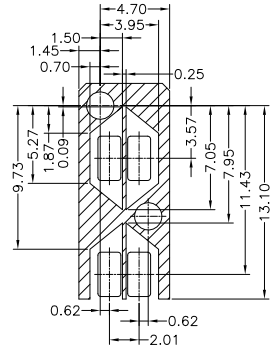

KEEP OUT  
ZONE DETAIL  
SCALE: 2:1

NOTE FOR (N):  
THE CURVED TAILS THAT GO INTO THE HOLES LOCATED BY THESE DIMENSIONS.  
TO ACCOMMODATE THIS CONVERSION, IT IS RECOMMENDED THAT BOARDS DESIGNED TO THIS PRINT  
REVISION INCLUDE THESE HOLES.

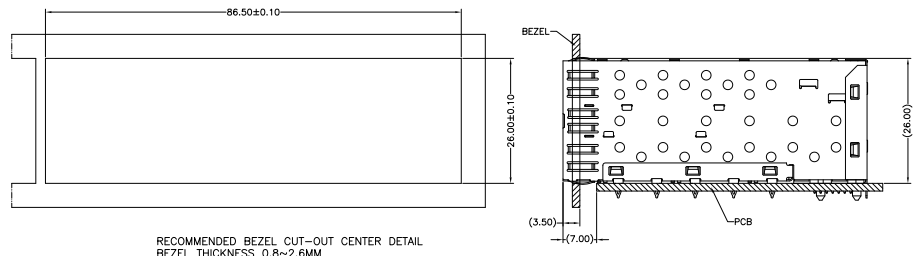

## ORDER INFORMATION

KLS1-SFP-020

Part Number