

CAT5E*CAT6*CAT6E Keystone Jacks

KLS12-DK7001 CAT6A keystone jack With shield

Electrical:

- 1.Voltage Rating:125 VAC RMS
- 2.Current Rating:1.5 AMP
- 3.Contact Resistance:100 Milliohms Max.
- 4.Insulation Resistance:1000 Megohms Min@500 VDC
- 5.Dielectric Strength:750 VAC RMS 60Hz,1 Min.
- 6.allows the transmission of gigabit ethernet:10GBPS

Mechanical:

- 1.Housing Material:Zinc Alloy.
- 2.Panel Frame:Carbon steel,powder coating in black color
- 3.IDC :PC UL94V-0 Contact:Phosphor Bronze with Nickel Plating
- 4.RJ45 Jack Life:750 Times Min
- 5.110 IDC Life:200 Times Min
- 6.Wire:AWG 23~24(0.58mm~0.51mm)



XII

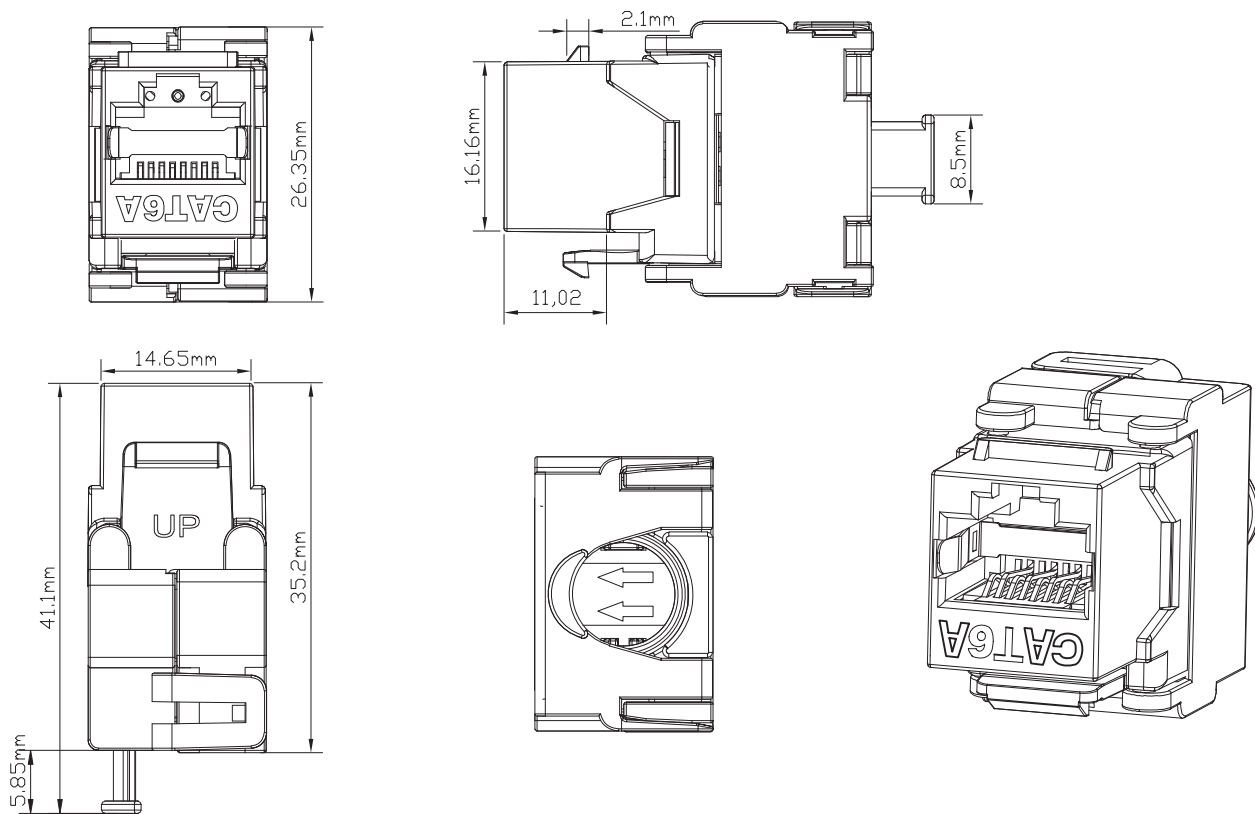

ORDER INFORMATION

KLS12-DK7001-01

Pos.NO.

Category 6A Screened Keystone Jack

01-Fu"
02-3u"
03-6u"
04-15u"
05-30u"
06-50u"