

DC Power Plug Series

KLS1-289 (DC Plug)

Technical parameters:

RATING: 100V AC Max or 12V DC 2A Max.
 Contact resistance: 50MΩ, max
 Insulation resistance: DC250V 50MΩ MIN.
 Pressure: 250V AC at 1 Minute
 Actuating Force: 3~20N
 Life: 5000 times
 Operating Temperature:-30°C ~ 70°C

Material:

Housing: PBT or ABS
 Contact: Brass, Tin plated

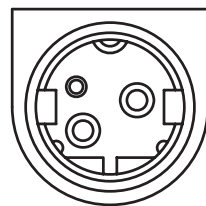
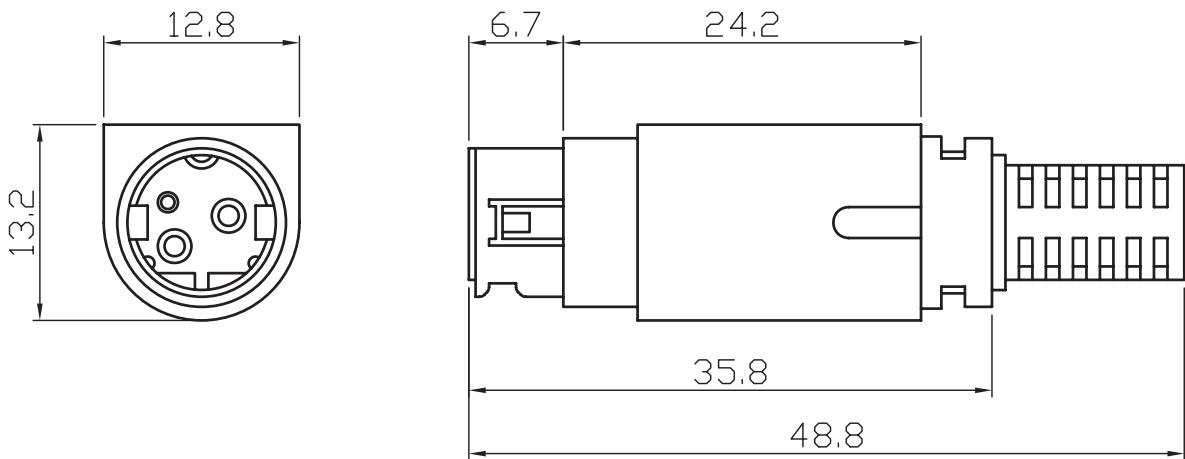

03-3 PIN

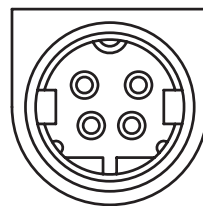

04-4PIN

ORDER INFORMATION

Product NO.: KLS1-289-03-3 PIN

