



Stereo Jack Series

KLS1-SPJ3.5-003 (SMD Stereo Jack)

Technical parameters:

- Rated voltage: DC 30 V
- Rated current: 0.5 A
- Contact resistance: 0.03Ω, max
- Insulation resistance: 100MΩ, min
- Pressure: AC500V (50Hz) / 1minute
- Insertion Force :2-20 N
- Life: 50000 times
- Operating Temperature:-30°C ~ 70°C

Material:

- Terminal 1 : Copper Alloy
- Terminal 2 : Copper Alloy
- Terminal 3 : Copper Alloy
- Terminal 4 : Copper Alloy
- Terminal 10 : Brass
- Terminal 11 : Brass
- Terminal 12 : Brass
- Shield : Stainless Steel
- Housing : PA6T

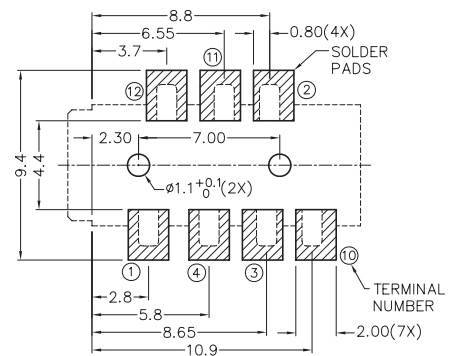
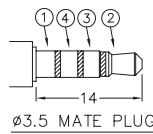
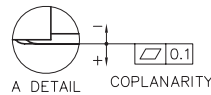
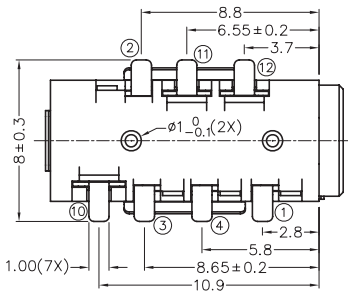
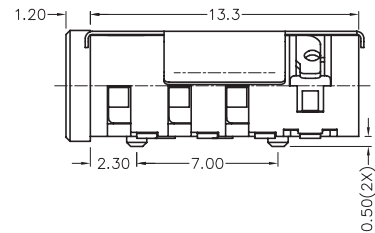
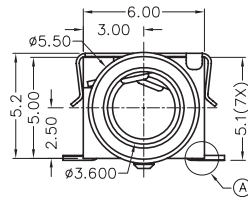
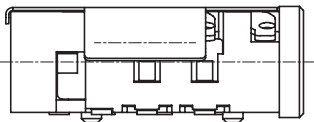

MODEL NO.	SPJ3.5-003	SPJ3.5-003A	SPJ3.5-003B	SPJ3.5-003C	SPJ3.5-003D	SPJ3.5-003E
SCHEMATIC						

RECOMMENDED
SOLDER PAD LAYOUT

ORDER INFORMATION

Product NO.: KLS1-SPJ3.5-003A

