

# TERMINAL BLOCK Connector

## Strip Series

### KLS2-FT011 Series

#### Material

Base: Flat-bottom  
Housing material: PA66, UL94V-2  
Terminal material: Brass  
Screws: Steel  
Working temperature: -40 ° C ~ +105 ° C  
Poles available: 2-12 Poles

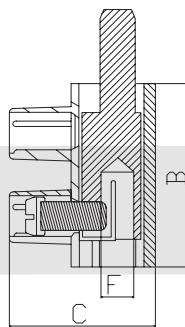
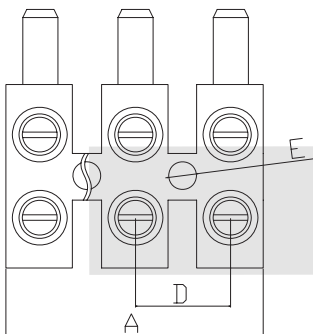
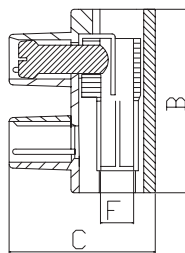
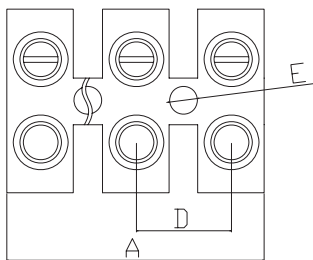
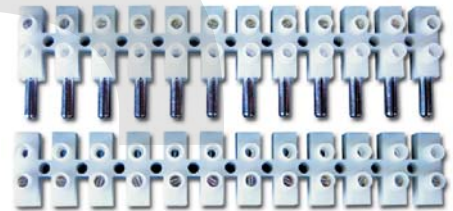

Model	Wire (mm <sup>2</sup> )	Amp	Volt	Screw	Dimensions(mm / in.)						
					Unit	A	B	C	D	E	F
8HP-0	1.5	17.5A	450V	M2.6x5	MM	96.0	17.8	14.3	8.2	3.0	2.80
10HP-0	2.5	24A	450V	M3.0x6	MM	116.5	20.0	15.5	10.0	3.5	3.3
12HP-0	6.0	41A	750V	M3.5x7	MM	140.7	23.8	17.8	12.0	3.9	3.9
14HP-0	10.0	57A	750V	M4.0x9	MM	158.0	25.6	24.0	13.5	4.4	4.8
16HP-0	16.0	76A	750V	M4.0x9	MM	169.8	28.0	21.8	14.5	4.2	6.0
18HP-0	25.0	101A	750V	M5x11	MM	194.4	36.9	27.5	16.5	4.2	7.5

## ORDER INFORMATION

Product NO.: KLS2-FT011-8HP-0-XX

Pos. NO. \_\_\_\_\_ Pin Number \_\_\_\_\_  
Series No. \_\_\_\_\_ See Drawing \_\_\_\_\_